

STARHOTELS®  
COLLEZIONE

# The Gore

LONDON

LIFESTYLE<sup>SM</sup>

*Preferred*

HOTELS & RESORTS

190 Queen's Gate  
Kensington  
London, SW7 5EX UK  
T + 44 (0) 20 7584 6601  
[Reservations.thegore@starhotels.com](mailto:Reservations.thegore@starhotels.com)  
[gorehotel.com](http://gorehotel.com)

BOOK

**T**he Gore is packed with history and brimming with Victorian eccentricity. Since opening in 1892, it has been renowned as one of London's most enchanting hotels and all in an enviable location among the high-life hotspots of Kensington and Knightsbridge. From antique carved beds to original paintings, each of the six floors is a treasure trove of period details and hand picked pieces. Take in sumptuous surroundings that have played host to photo shoots and iconic album launches. Step out for a stroll through Hyde Park, or an evening at the Royal Albert Hall. Then retreat to The Gore's elegant Bar 190 for the perfect post-concert nightcap.

### GDS Code

Amadeus: PH LONTGH  
Apollo / Galileo: PH 48921  
Sabre: PH 4107  
Worldspan: PH LONGO

### Rooms & Suites

The Gore's 50 individually unique bedrooms are often described as among the most enchanting in London. All of the rooms are furnished with hand-picked pieces, period pictures and ornate feature beds.

### Restaurant & Bar

190 Queen's Gate Restaurant is where our guests come to enjoy excellent food, created from the best ingredients. Our Bar 190 is famous for being the location for the Rolling Stones "Beggars Banquet" album launch in 1968.

### Services

We offer thoughtful assistance throughout your stay with Les Clefs d'Or concierge, 24-hr room service, Wi-Fi and a peaceful library.

### Meetings & Events

We provide a unique and unforgettable backdrop for your meeting or event. Our 3 meeting rooms for up to 120 people will help deliver your meeting or a cocktail party, wedding ceremony or a grand reception.







### Location

The Gore Hotel is situated between Knightsbridge and Kensington, opposite Queen's Gates to Hyde Park. We are just around the corner from the Royal Albert Hall and moments from Kensington Palace while Knightsbridge shopping, including Harrods and Harvey Nichols, is just a short stroll away. The Gore is a five-minute walk from Kensington High Street, the museums of South Kensington and within easy reach of the West End.

### From St Pancras Station

- From this station travel by London Underground from Kings Cross/St Pancras Station directly to South Kensington Station. You will be travelling Westbound on the Piccadilly Line (dark blue). We are located 10 minutes away walking distance from the station. Once you have come out of the main station entrance you need to walk down Cromwell Place to reach Cromwell Road. Turn left onto Cromwell Road (A4) and walk past National History Museum towards Queen's Gate. At the intersection with Queen's Gate turn right and walk down towards Hyde Park. We are located at 190 Queen's Gate.

### From the M25 & M4 Motorways

- Arriving via the M25 exit at Junction 15 & join the M4 Eastbound. Travel 10miles along the M4 until the Motorway ends & becomes the A4. Continue another 5miles & follow signage for 'Central London' until you reach South Kensington & the Museum district. You will pass Gloucester Rd Underground Station. At the next set of traffic lights turn left on Queen's Gate and drive down towards Hyde Park. We are located at 190 Queen's Gate.

### From London Heathrow Airport

- From any Heathrow Underground Station travel directly to South Kensington Station. You will be travelling Eastbound on the Piccadilly Line (dark blue). We are located 10 minutes away walking distance from the station. Once you have come out of the main station entrance you need to walk down Cromwell Place to reach Cromwell Road. Turn left onto Cromwell Road (A4) and walk past National History Museum towards Queen's Gate. At the intersection with Queen's Gate turn right and walk down towards Hyde Park. We are located at 190 Queen's Gate.

### From London Gatwick Airport

- From Gatwick Airport Railway Station travel directly to Victoria Station via the Gatwick Express. Journey time is 30mins. Upon arriving at Victoria Station move downstairs to Victoria Underground Station & travel directly to South Kensington Station. You will be travelling Westbound for two stops on the District (green) or Circle Lines (yellow). We are located 10 minutes away walking distance from the station. Once you have come out of the main station entrance you need to walk down Cromwell Place to reach Cromwell Road. Turn left onto Cromwell Road (A4) and walk past National History Museum towards Queen's Gate. At the intersection with Queen's Gate turn right and walk down towards Hyde Park. We are located at 190 Queen's Gate.



### 3 meeting rooms

All meeting rooms are equipped with: Wi-Fi (at a charge), sound system, screen, LCD projector<sup>(1)</sup>, flip chart, other services are available upon request.

<sup>(1)</sup>Max one LCD projector complimentary, additional requests at a charge

Meeting rooms	Area mq / ft.	L x W mt. / ft.	Height mt. / ft.	Theatre	Class room	Conference table/ U-shape	Cabaret style <sup>^</sup>	Cocktail reception	Banquet
Green Room °	44 474	8,00x5,50 26,25x18,05	4,2 13,78	20	10	10	30	50	24
Mulberry Room °	32 344	6,70x5,50 21,98x18,05	2,8 9,19	20	10	10	20	20	15
Tapestry Room °	65 700	14,00x5,40 45,93x17,72	2,8 9,19	60	20	16	40	120	60
Mulberry & Tapestry °	97 1044	6,70x5,50+ 14,00x5,40 21,98x18,05x 45,93x17,72	2,8 9,19	90	30	26	60	150	75
190 Queen's Gate Restaurant	60 646	8,00x6,90 26,25x22,64	2,8 9,19	-	-	-	-	75	48
Bar 190 °	90 969	13,00x7,90 42,65x25,92	2,8 9,19	-	-	-	-	100	-

° Daylight

<sup>^</sup> Cabaret style: Size tables diameter 150 cm



STARHOTELS®  
COLLEZIONE

The Gore  
LONDON

190 Queen's Gate, Kensington  
London SW7 5EX UK  
T +44 (0) 20 7584 6601  
events@gorehotel.com gorehotel.com

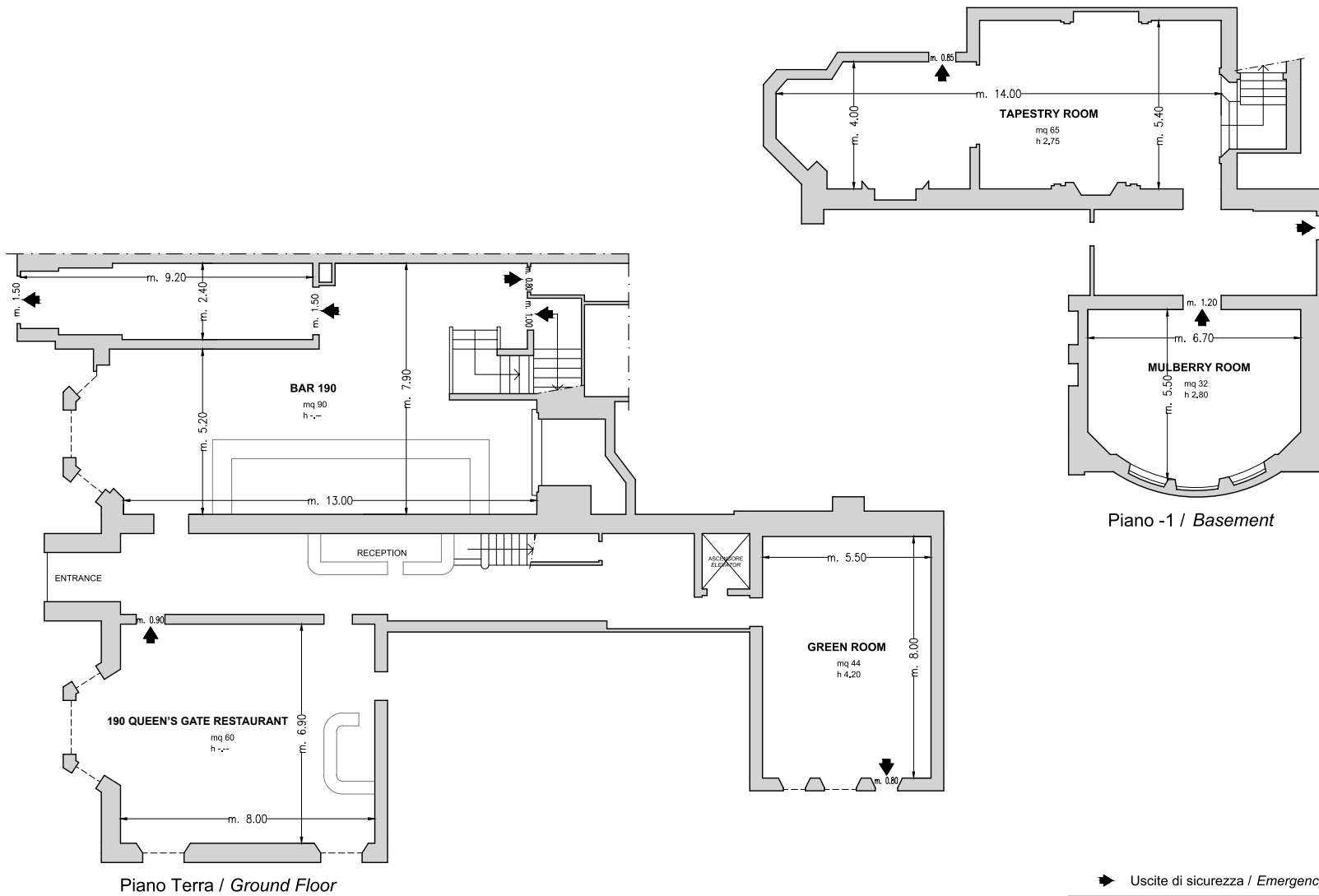

3 meeting room fino a 90 persone / 3 meeting rooms up to 90 seats